

## HIGH FLOW INSIDE MITER

# Installation Guide

### Recommended Tools

- Tin Snips/Dremel
- Extension Ladder
- Gloves
- Drill
- Safety Glasses
- Tape Measure

#### ONLY NEEDED FOR INSTALL OPTION 2:

- Commercial or Wooden Brake

## Safety Is Our #1 Priority.

#### During installation we recommend that you...

- Wear gloves and safety glasses.
- Use an extension ladder and standoff for stability.
- Make all cuts and bends to the gutter guards on the ground.

#### ALSO MAKE SURE TO:

- Obey local building codes.
- Check to see if your roofing material is adhered to your underlayment. Do not pry up your shingles or tear your underlayment.
- Remove any labels/stickers from the gutter guard piece as needed.

#### FREEZING CONDITIONS

If you live in an area that is prone to freezing, the following issues can occur with any gutter guard:

##### *Icicles & Ice Dams*

Icicles and ice dams may form on your gutter during freezing conditions. Ice dams can cause water to leak back into your home. Icicles can break and cause serious bodily harm and injury. Properly installed, operated and maintained heating elements on your roof and gutter can melt icicles and ice dams. Use a local licensed electrical contractor in good standing for installing any heating element products.

##### *Snow Melting*

Snow melt may result in water runoff from your roof which can refreeze on the ground below creating a potential slipping hazard.

## Important Reminders

Missing these steps can result in rainwater runoff.

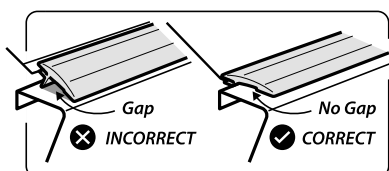

#### Remove The Gap

There should be no space between the front rail and the gutter lip when you install.

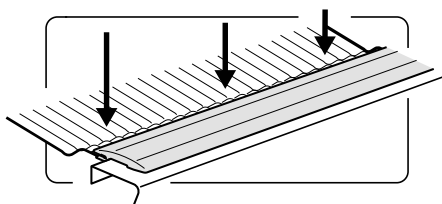

#### Create A Trough

Mesh trough should be at least 1/8" below gutter lip. Use fingers to push mesh trough down.

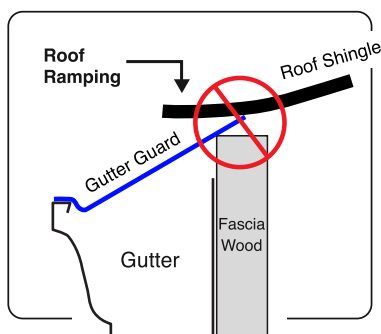

#### Avoid Roof Ramping

Shingles lifting upward will cause water to run over the gutter guard, instead of allowing water to flow onto and through the gutter guard.

# Installation: Start Here

## Step 1

### Prepare Installation

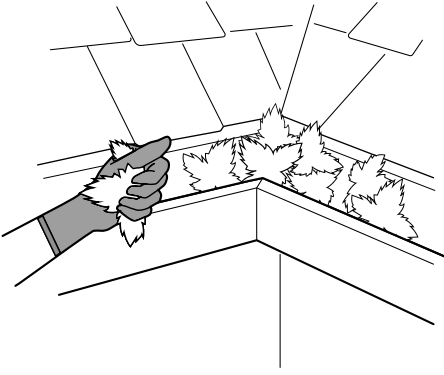

LeafBlaster Pro® High Flow Inside Miters were designed to allow proper water flow in areas where roof valleys channel excessive volumes of water.

**Make sure to follow the same “Pre-installation” and “Proper Installation” instructions that are outlined in our gutter guard installation manuals & videos.**

## Step 2

### Install Inside Miters

*The miters can be installed using either the under-shingle or below-the-roofline method. Use the same method for the inside miters that is used to install the gutter guards on the home. This will ensure that the inside miter sections properly align with the adjacent gutter guards.*

#### Option 1: Standard Roof Installation (Under-Shingle Method)

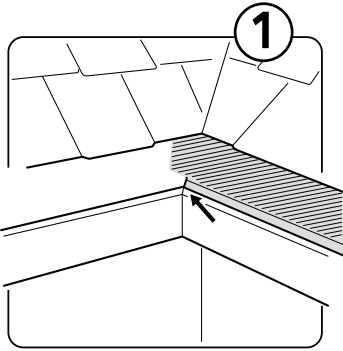

Carefully lift the front shingles and slide the back rail of the miter section underneath.

The pre-cut 45-degree side of the miter should sit on the front corner of the gutter.

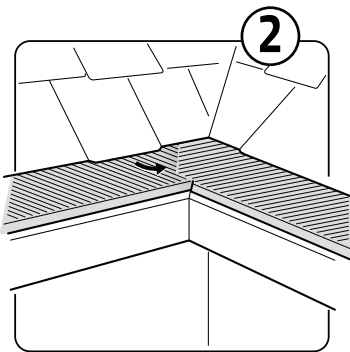

Repeat the process to install the other side of the miter, making sure the two sections meet flush at the front corner of the gutter. The mesh will overlap approximately 2 inches in the center.

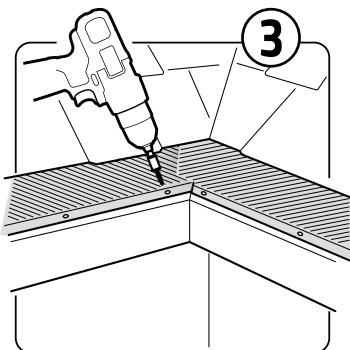

Once both sections are in place, screw the front rail of each section to the front lip of the gutter using 2 screws per section.

Check the overlapping mesh to make sure it is lying flat. Flatten any areas that could trap debris.

## Option 2: Below-The-Roofline Installation (Bend Method)

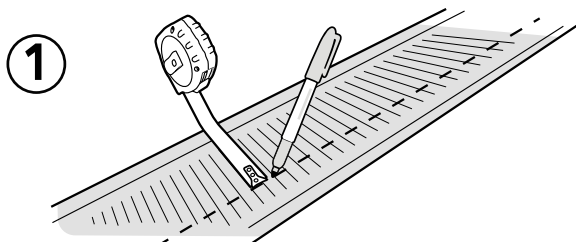

**MEASURE & MARK:** Measure and mark on the miter section where to place the bend in the mesh

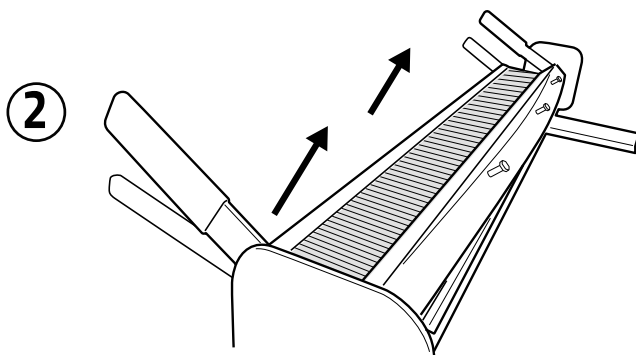

**BEND THE MESH:** Bend the mesh up or down, depending on your installation method, using a commercial or custom wooden brake.

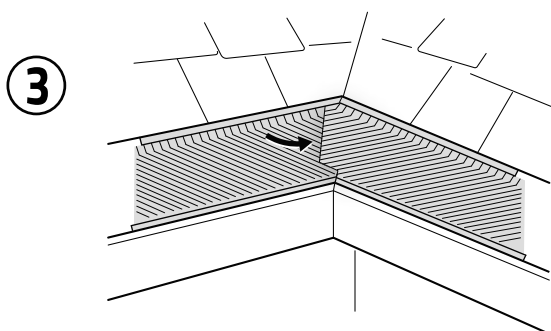

**INSTALL GUARDS:** Place the first pre-cut side of the miter into the corner of the gutter. Overlay the second side, making sure the two sections meet flush at the front corner. The mesh will overlap approximately 2 inches in the center.

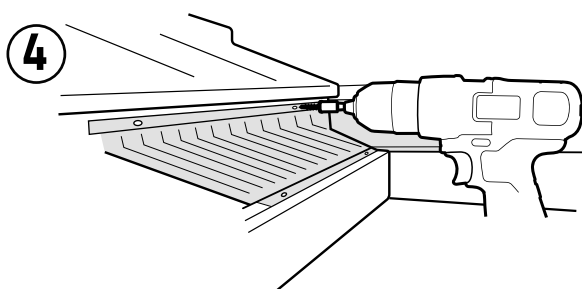

**SCREW IT DOWN:** Once both sections are in place and properly sloped, screw the front rail of each section to the front lip of the gutter, and the back rail, or mesh, to the fascia.

Check the overlapping mesh to make sure it is lying flat. Flatten any areas that could trap debris.



*For added strength, join the two miter sections together while on the ground. Use a pulled strand of mesh wire from one of the cut ends to twist-tie them at a few locations where the mesh overlaps. Insert the folded strand of mesh from the top down and twist tight from the underside, leaving a smooth surface on the top side of the miter.*



# Need More Help?

[CLICK HERE](#)

for Installation Videos  
and More Information at

[LeafBlasterPro.com/Contractor-Resources](http://LeafBlasterPro.com/Contractor-Resources)



or Contact Our Support Team:

[customerservice@gutterglove.com](mailto:customerservice@gutterglove.com)

**886.483.8166**

Monday-Friday 8am-7pm CST

## COMPLETING THE JOB

# LeafBlaster PRO®

Thanks for  
Choosing  
LeafBlaster Pro!

1

Clean up the  
jobsite.

2

Ask for a great review  
and a referral!

Submit your project or invoice for  
rewards in the LeafBlaster Pro  
Contractor Loyalty Program!

**JOIN NOW!**

✓

## SHARE YOUR GOOD WORK!