

LeafBlaster PRO[®]

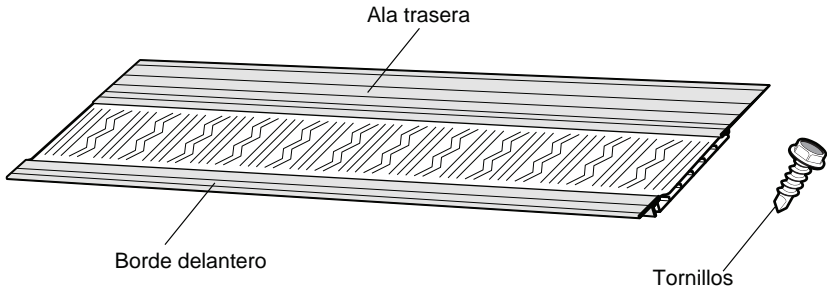

Fijas de protector de canal 5n de l]ies de longitud



- 6LUUDELUFODUBGERUW (FDOUDGQ
- LMUDGBMDODWUR WLy
- DW • DODGUR
- DIDGOLGDG • LWDEpWULFD

UDWDDWDODFLyDDFRPGDPRDD
 • 8WLOLFDWDIDGOLGDGQ
 • 8WLOLFDDEDOUW/LEOQ
 SDUDGRUSDUDBRUW/DELOLGDGQ
 • 5DOLFWRGRFRBRUWGDQ
 SURWFFLRGOEDDOyDORO

0,e16(5Q
 • 2EGFDDREyGLRGRWUFFLyQ
 ORFDO
 • 5WLUODW/LTWSDSWLDBGDSLDGQ
 SURWFFLyGOEDDOyDEDLURQ
 • RPSUEODBWULDGBELUWWDWQ
 DGULGRDORWUDSLRFRDWDWMDQ
 LDDORWUDSLRQ BOWDDBSFLyQ
 GDDGQWDDODFLyQ

GDSUDDDDWDODFLyQ
 (WDEBEUDDWDODFLyWiGDUBLD
 FLWDDWUFFLRDGLFLRDOBDDQ
 FRWDFWRBRBRWURDQ
 DDSDUDBEWUDGDQ

21,,21(6Q1(/,1Q
 6LBUDDDBDSURSDDDDDGDGQ
 LIRUPDOBOLWGBSGSURGFUORO
 LLWSUREOPDBREDOTLUBURWFRUGQ
 FDDOR

DUIPEDRGLTGOROQ
 (BRGLFLRGRBRODFLySGRUPDUQ
 FDUiPEDRGLTGORODDDOyFRGLTO
 GORSGSURRFDUQDDDDFLDDWULRUQ
 GDDDLGDREDUiPEDRSGORPSUQ
 FDDUOLRQDxRERUSRUDODDORO
 OPWRBDOIDFRURBRUUFWDPWDWODGRQ
 RSUDGRBDWLGRDWMMDGRDDEDDOySGQ
 GUUWLUORREDUiPEDRORGLTGORBFUDDQ
 BRWUDWLWDDpFWULFRORFDOBROLFFLDDODSDUDDQ
 LWDDODFLyGBDOTLUOPWRBDOIDFRURQ

UUWLPLWRGDQ
 (OGLORSGSURRFUDDDDOLGDGDDGOMMDGRQ
 TSGROUDBRFODUDDDRBUDGRQ
 SOLURBRWFLDQGBEDORO

Important Reminder

Missing this step can result in rainwater runoff.

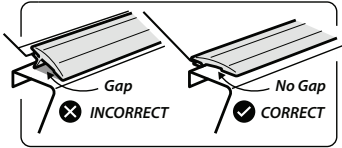

Remove the Gap
There should be no space between the front rail and the gutter lip when you install.

Step 1

Clean And Repair Gutters

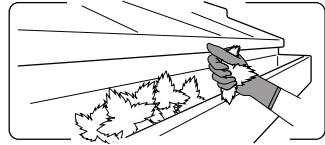

Step 2

Determine Gutter And Roof Slope

Select the option that best resembles your gutter and roof scenario. Once you've identified the roof scenario that best fits, proceed to the corresponding step. LeafBlaster Pro gutter guards can be installed with all roof shingle and gutter types

Option 1



Standard Roof
If your roof looks like this, continue to **OPTION 1**.

Option 2

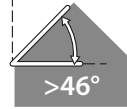

Steeply Pitched Roofs
If your roof looks like this, continue to **OPTION 2**.

Option 1: Standard Roof Installation

Frame-Reinforced Stainless Steel Micro-Mesh gutter guard is designed to slide underneath roof shingles with the optimum slope for gutter guard install being 5-25°. If any of the following situations occur during installation, we recommend installation option 2:

- The roof is steeply pitched, resulting in a slope beyond 25°
- The gutter guard causes the roof shingle to start ramping when slid underneath
- If gutters are installed low below the roofline, causing a steep slope from the roof to the front of the gutter.

Option 2: Below The Roofline Installation

If your roof is steeply pitched or you have a low hanging gutter, the gutter guard will need to be installed against the fascia. We recommend installing the LeafBlaster Pro Fascia Mount as a support bracket. The gutter guard will need to be installed at a slope of 5-10°.

Trim the extruded aluminum wing (wider rail frame of gutter guard) to allow the gutter guard to match the width of the gutter.

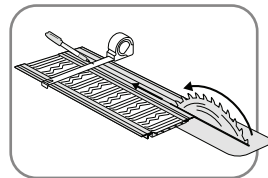

Step 3

Measure And Cut The Gutter Guard As Needed

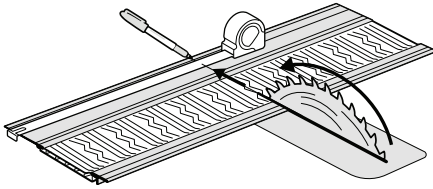

Firmly fasten or clamp Frame-Reinforced Stainless-Steel Micro-Mesh gutter guard to a secure flat surface. Use a circular saw or chop saw (make sure to wear safety goggles!) to cut through the aluminum frame and stainless steel micro-mesh to fit the length and width needed for your installation.

Step 4

Begin Laying First Section

We recommend starting at an inside corner. If there isn't one, start at the downspout.

Option 1: Standard Roof Installation

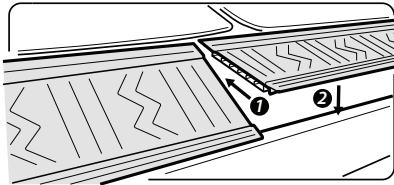

Carefully slide the rear wing of the gutter guard under the roof shingles. Where the mesh extends past the frame on both ends, carefully bend the mesh down so each gutter guard can butt up close to the next. Continue to step 5.

Option 2: Below The Roofline Installation

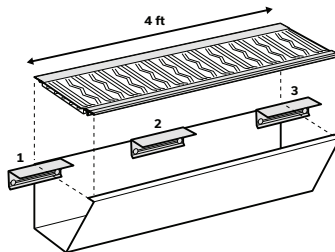

Install LeafBlaster Pro Fascia Mount using the installation instructions provided.

Carefully lay the gutter guard with the cut rear wing laying on the fascia mount to support the gutter guard. Continue to step 5.

Step 5

Use Screws To Attach

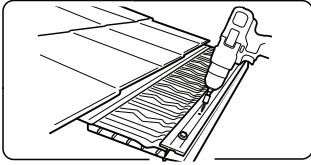

Use the scribe line on the front rail as a guide to place 3 screws for each section. Fasten the screws through the gutter guard rail to the front of the gutter.

Important: When the mesh extends past the end of a section, bend the mesh down to allow another section to butt up against the previous section. **Pro Tip:** Use an aluminum thumb to cover the seams in the gutter guard installation.

How-To: Inside Miters

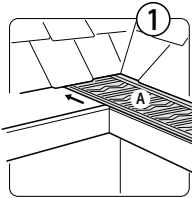

Slide first section all the way to the inside corner of the gutter.

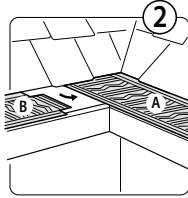

Take a second section of the gutter guard and bring it into the corner to butt up against the first section used in step 1 to form a 90° angle.

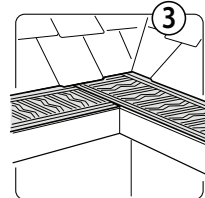

This is a completed inside corner.



PRO TIP

If there is a gap due to height differences between the two gutter guard sections, use a scrap piece of mesh or coil aluminum to cover the gap and seal the gutter.

How-To: Outside Miters

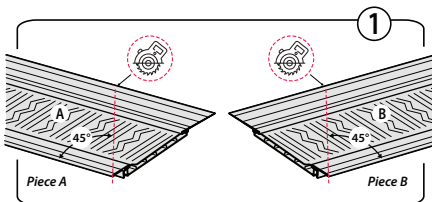

Prior to installing, use a circular or chop saw to cut a 45° angle at the opposite ends of two separate sections.

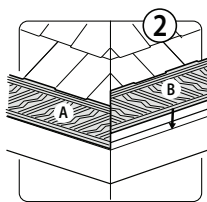

Place the two sections with the cut ends next to one another at the outside miter.

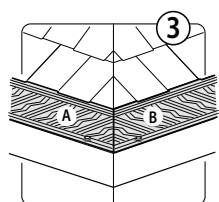

Affix to the outside edge of the gutter and fasten with screws



PRO TIP

To provide a more finished look, we recommend fastening an aluminum thumb over the seam.

How-To: End Caps

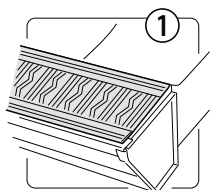

Use a spare piece of mesh or piece of coil aluminum and cover the ends of the guard by bending and wrapping around the end.

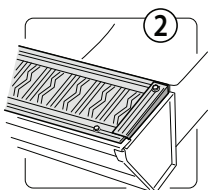

Use a screw(s) to fasten the shaped material to the gutter guard.

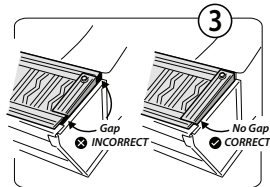

Make sure the entire gutter end is sealed to prevent debris and pests from getting under the gutter guards.

COMPLETING THE JOB

LeafBlaster PRO

Thanks for
Choosing
LeafBlaster
Pro®!

1

Clean up the jobsite.

2

Hand your customer the warranty card.

3

Ask for a great review and a referral!



A JOB
DONE RIGHT

Need help or have questions during installation?

Please contact our support team

customerservice@gutterglove.com | 886.483.8166 | Monday-Friday 8am-5pm PST